

AQUAPANEL®

Access Panels

for AQUAPANEL® Cement Board Indoor



AQUAPANEL® access panels are protected against water spray and can be installed in partition and plumbing walls or wall linings.

Application

AQUAPANEL® access panels can be installed in all partition and plumbing walls built with AQUAPANEL® Cement Board. They are easy to install and safe to handle. Walls lined with AQUAPANEL® Cement Board Indoor and including inspection covers are waterproof (Test report BBW 0215069, LGA Bavaria).

Handling & installation

The size and position of the access panel opening depends on the tiled section. The front clear opening (front CO) dimension depends on the size and width of the tile. The clear opening (CO = size to be ordered) is 20 mm smaller than the front clear opening.

When building the wall substructure, make the opening for the access panel suit the tiled section. The dimension of the opening in the substructure is 85 mm larger than the clear opening.

Then install the outer frame, which should be aligned in accordance with the tiled section. Fix in place avoiding any distortion. Align the closing system towards the ceiling. Screw the outer frame to the wall substructure and adjust and secure the inside cover safety chains. Then place the inner cover in position, check that it functions properly, and finish the wall panelling.

Vertical section access panel

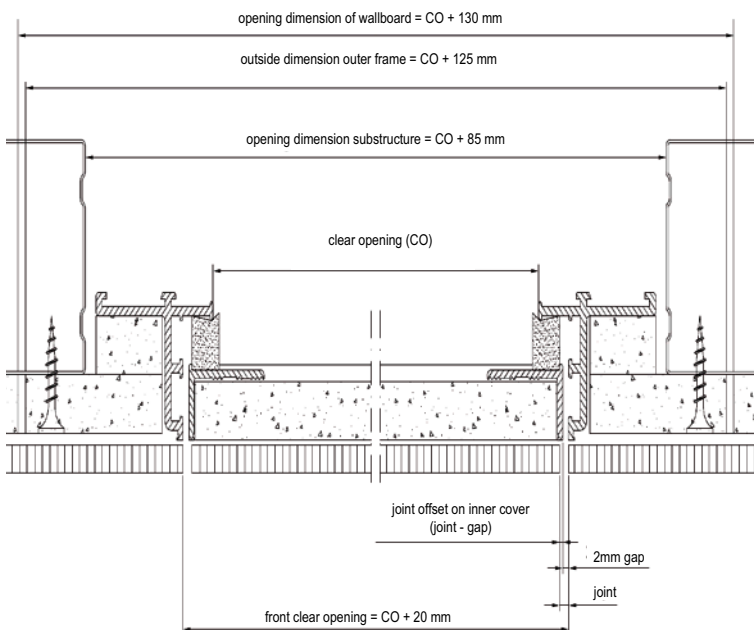

Cover the entire wall surface with AQUAPANEL® Interior Primer and affix and grout the tiles for the tiled section using the thin-bed technique. Finally, check for correct functioning and cut the joint sealing to size and fit.

Installation time

Approx. 30 – 45 minutes (depending on the size and accessibility of the opening in the substructure).

Method of delivery

Panelling with AQUAPANEL® Cement Board Indoor

Panel thickness (mm)	12,5
	2 x 12,5
Standard sizes (width x height)*	300 x 300
(= size to be ordered)	400 x 400
	500 x 500

* Other sizes available on request.

Note

Special features for ceiling applications. Access panels can also be installed in ceiling constructions. When ordering, please state you require this accessory for a ceiling application.

Item codes:

300 x 300 mm: 95711
 400 x 400 mm: 95712
 500 x 500 mm: 66088

Schematic diagram for tile laying

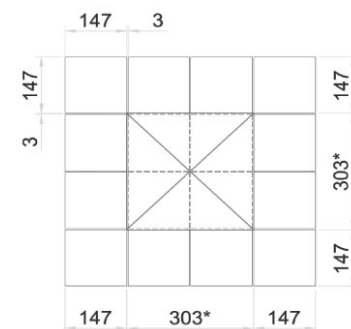

* front internal dimensions
 Gap + tile + gap + tile + gap =
 $3 + 147 + 3 + 147 + 3 = 303$ mm