

Installation

1. Post profiles

1.1 AQUAPANEL® Cement Board Indoor can be mounted on a wall framework made from either metal or wooden profiles.

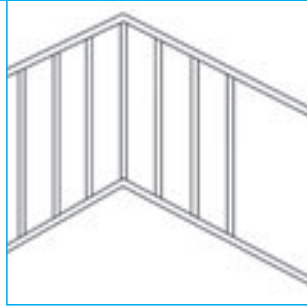

1.2 The connection profile on either side must be coated with partition wall putty or sealing tape. Rotary pin dowels or other fasteners are used to secure the profiles to the walls.



1.3 Mark out the path of the AQUAPANEL® Cement Board Indoor wall. All runners are fastened to the floor and ceiling. Profiles are cut to length and then spaced 62.5 (60) cm apart. Set and align these profiles with the floor and ceiling profiles. Connect the wall connection studs to the end walls on either side.



2. Align the board

Align the first AQUAPANEL® Cement Board Indoor panel along the profiles. Ensure that the board is aligned correctly horizontally and vertically using a spirit level. Screw spacing to be $\leq 250\text{mm}$. Distance from edges $\geq 15\text{mm}$. *Do not overdrive fasteners.*

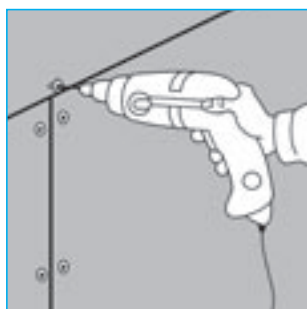
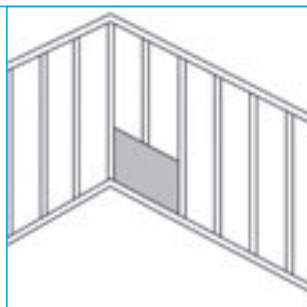

3. Clean the edge of the board

In order to ensure a good connection with the AQUAPANEL® Joint Adhesive (PU), clean the edges of the board using, for example, a wet brush.

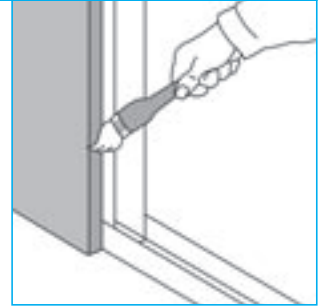

4. Apply the joint adhesive

4.1 Apply the AQUAPANEL® Joint Adhesive (PU).

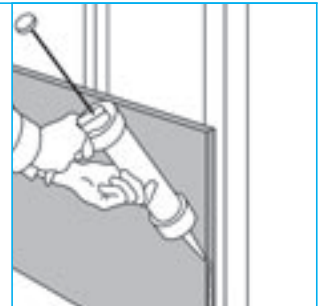

This must be done before the next board is placed.

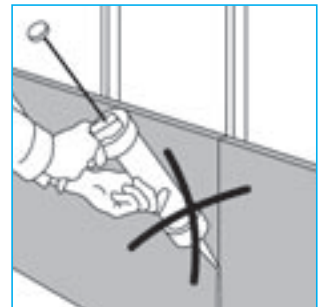

4.2 Insert the AQUAPANEL® Cement Board Indoor into the bed of adhesive. Screw panel to the framework. Joint reinforcement of the AQUAPANEL® Cement Board Indoor panel is achieved by means of the adhesion technique. There is no need for the time-consuming process of filling and inserting joint tape.

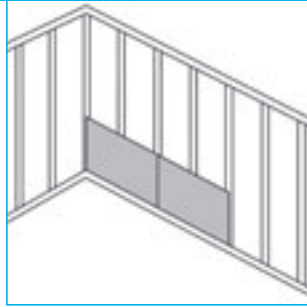

4.3 The AQUAPANEL® Joint Adhesive (PU) must be applied as a continuous bead along the edges of the boards. Before applying the adhesive, ensure that the edges are cleaned using, for example, a wet brush. It takes approximately 50ml/m² (25ml/m). The tube contains enough adhesive for approximately 6m².

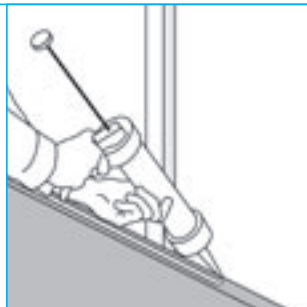

5. Place next board
Install the next AQUAPANEL® Cement Board Indoor panel and ensure that the boards are correctly aligned horizontally and vertically. Screw panel to the framework.

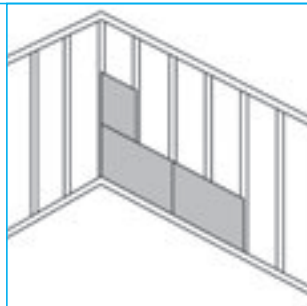

6. Scraping off
Leave the adhesive to harden after which the excess AQUAPANEL® Joint Adhesive (PU) can be scraped off (usually the next day).

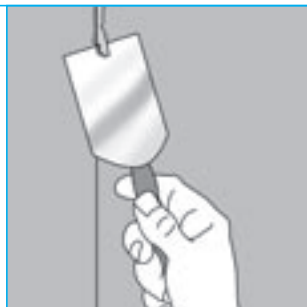

7. Completed wall
The joints between the walls, ceiling and floor require permanent elastic sealing in dry areas. Expansion joints should be at a minimum of 7.5 (7.2) m intervals.

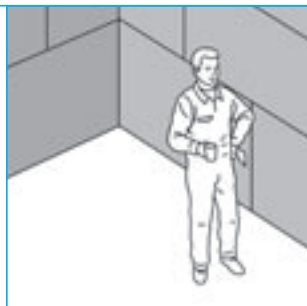

8. Priming
AQUAPANEL® Cement Board Indoor must be primed before tiling or finishing using AQUAPANEL® Interior Primer.

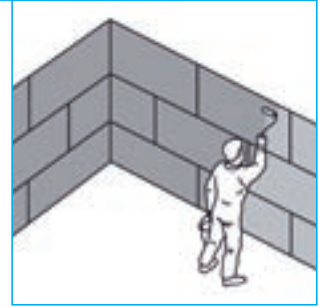

Curved walls

For applications such as arches AQUAPANEL® Cement Board Indoor can be curved.

Using metal shears, cut the UW-profile.

Fit the UW-profile to the desired radius.

Crimp the CW-profile to the perforated UW-profile.

Before installation, bend the cement board panel. The fine cracks that occur on the board surface will not cause any loss of performance.

Board size:
1200/2400/1250/2500 x 900 mm
Minimum bending radius ≥ 3 m

Strip size:
1200/2400/1250/2500 x 300 mm
Minimum bending radius ≥ 1 m

Max. stud spacing:
 $\leq 300/312.5$ mm (external radius)

