

# Water-managed system (directly-applied)

## Installation

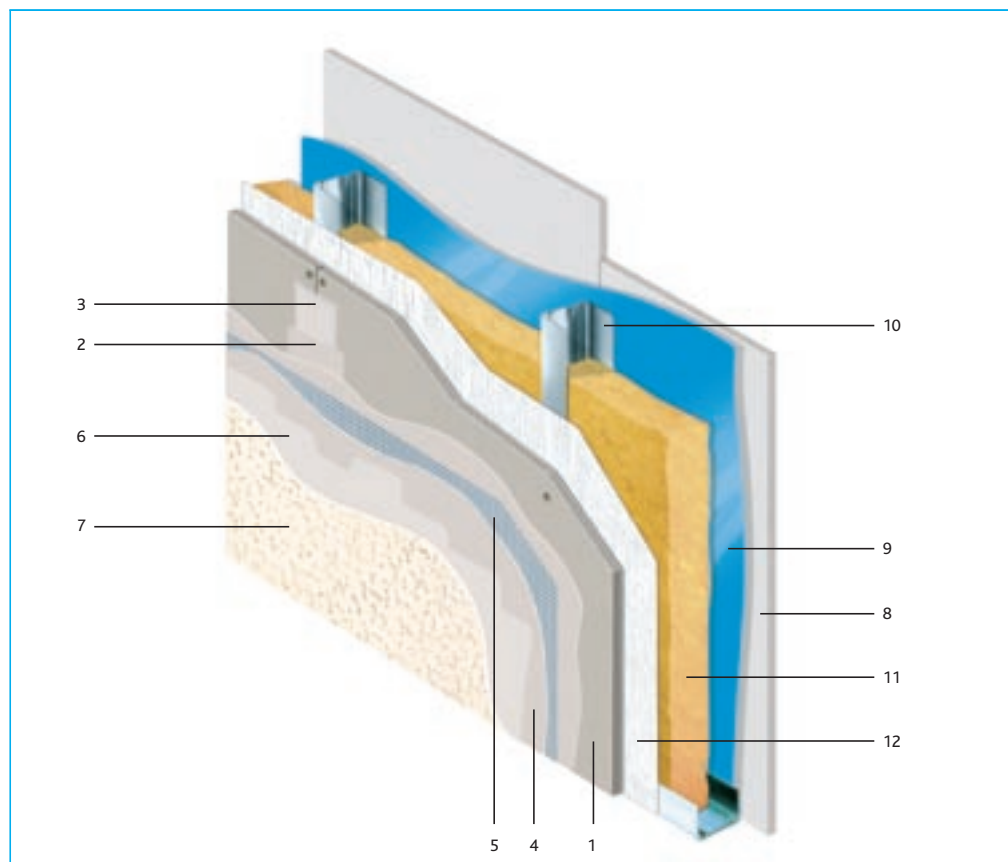

### Key

- 1 AQUAPANEL® Cement Board Outdoor
- 2 AQUAPANEL® Joint Filler – grey
- 3 AQUAPANEL® Tape (10 cm)
- 4 AQUAPANEL® Exterior Basecoat
- 5 AQUAPANEL® Exterior Reinforcing Mesh
- 6 AQUAPANEL® Exterior Primer
- 7 AQUAPANEL® Exterior Silicon Synthetic Resin Plaster – white or AQUAPANEL® Exterior Dispersion Plaster – white
- 8 Knauf gypsum board
- 9 Vapour barrier
- 10 Framework
- 11 Insulation
- 12 AQUAPANEL® Tyvek® StuccoWrap™

## Installation – water-managed system

### 1. Create substructure

The steel or timber framework must be designed according to the static requirements of the construction. The centre distance of the substructure is a maximum of 600/625 mm o.c. in this case.

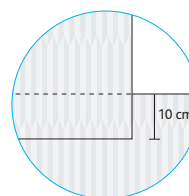
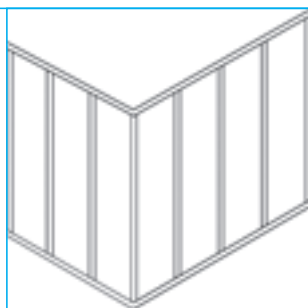

A minimum overlap of 10 cm is marked on the AQUAPANEL® Tyvek® StuccoWrap™.

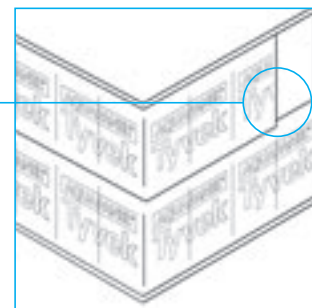

### 2. Attaching AQUAPANEL® Tyvek® StuccoWrap™

2.1 A water barrier is required behind cement board in this application. Use AQUAPANEL® Tyvek® StuccoWrap™ as the water barrier. When installing this, start at the foot of the wall and install the water barrier in a shingle lap manner. Overlap all horizontal and vertical joints a minimum of 10 cm.

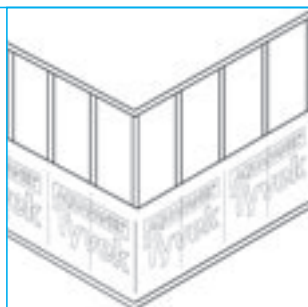

2.2 Secure the water barrier membrane with adhesive tape or adhesive and immediately apply AQUAPANEL® Cement Board Outdoor panels.

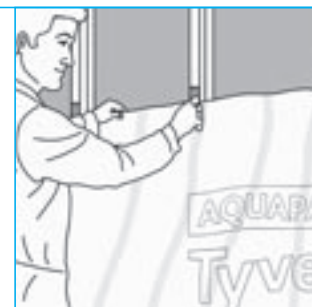

*Installation guide*

### 3. Installation with screws

The AQUAPANEL® Cement Board Outdoor boards are attached with AQUAPANEL® Maxi screws onto the metal or timber supporting frame. Where appropriate, AQUAPANEL® Rustproofed Screws are to be used to attach the boards to the wooden framework. First fasten the screws into the centre of the cement boards; then work towards the ends and the edges. When installing, make sure the cement boards rest on the framework.

*Screws should not be overtightened.*

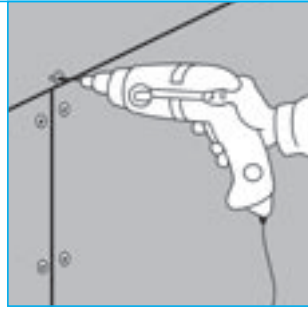

Screw spacing  $\leq 250$  mm.  
Space from the edges  $\geq 15$  mm.

4.2 Take the boards up to the window and down to the window ledge. There must be no continuous joints as these could lead to tears and leaks.

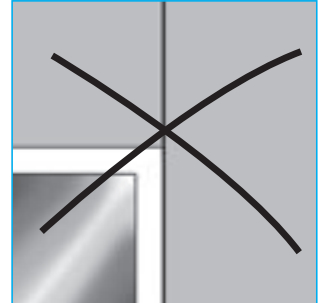
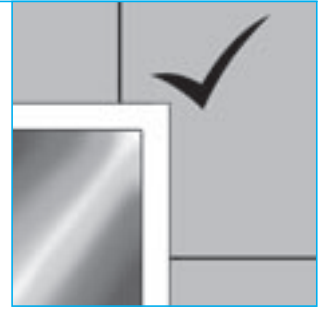

### 4. Arrangement of boards

4.1 Apply AQUAPANEL® Cement Board Outdoor panels horizontally with ends over framework. Leave a gap of 3-5 mm between boards using a suitable spacer. When fitting the subsequent rows of boards, ensure that the vertical joints are offset a minimum of one stud cavity.

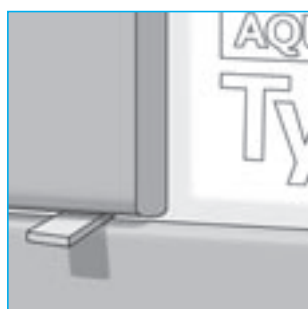
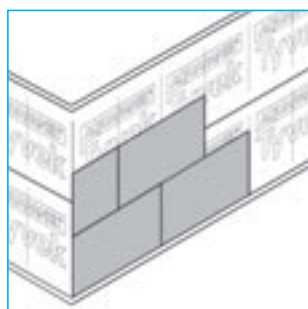
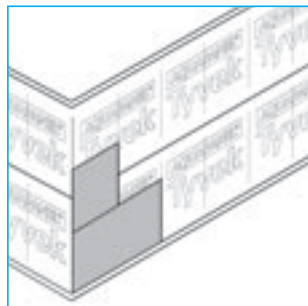
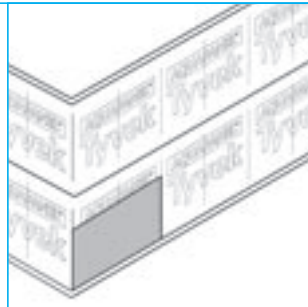

### 5. Joint treatment

5.1 Immediately after assembly, protect the framework from weathering by filling all the joints with AQUAPANEL® Joint Filler – grey.



5.2A Immediately embed AQUAPANEL® Tape (10 cm) centred over all joints.

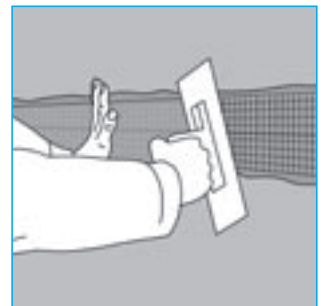

5.2B If only one coat of paint is to be applied onto AQUAPANEL® Exterior Basecoat, use AQUAPANEL® Exterior Reinforcing Tape which has a width of 33 cm.

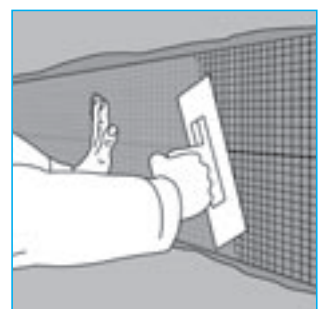

5.3 Fill the screw heads with AQUAPANEL® Joint Filler – grey.

Notes on preparing the surface for finishing can be found in the information on page 17.

